



The EEI of ALPHA1 meets and exceeds the requirements of the EuP 2015 legislation.

ALPHA1 AFFORDABLE ENERGY EFFICIENCY

The ALPHA1 is a cost-efficient yet high-performing circulator. The reliable pump complies with the strict EuP requirements and is the ideal choice in applications where the well-known UPS has been used to fulfil basic circulator needs.

The ALPHA1:

- is based on the field proven ALPHA2 with more than 3 million units sold
- cuts energy consumption by up to 80% compared to traditional pumps
- uses as little as 81 kWh per year (based on 150 m² standard house with 6840 heating hours per year)
- is adaptable to any type of heating system – one- or two-string – with radiators or under floor heating.

TECHNICAL DATA

| | |
|--|---------------------------|
| Supply voltage: | 1 x 230 V – 50/60 Hz |
| Flow rate, Q_{max}: | 2.4 m ³ /h |
| Liquid temperature: | +2° C to +110° C (TF 110) |
| System pressure, P_{max}: | 1.0 MPa/10 bar |
| Power Range: | 5-45 W |
| Ambient temperature: | 0° C to +40° C |
| EEI: | ≤ 0.23 |
| Enclosure class: | IP 42 |
| Insulation class: | F |

PERFORMANCE CURVES

ALPHA1 XX-40

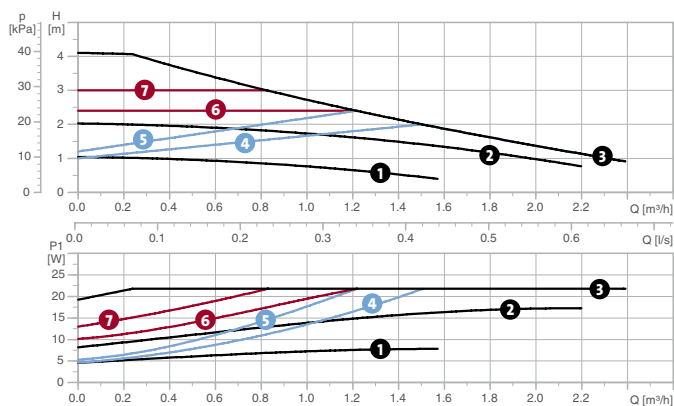

ALPHA1 XX-60

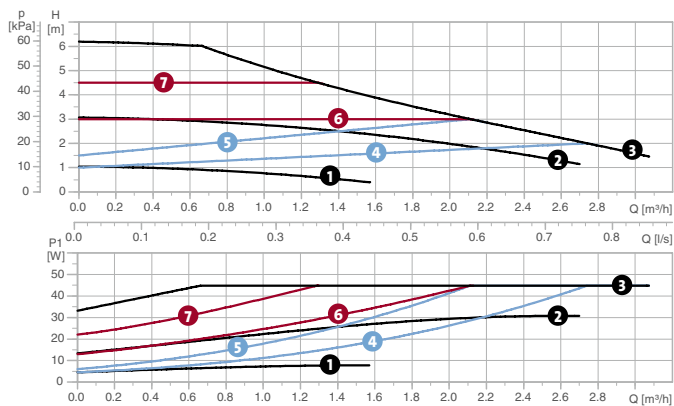

1. Constant speed curve 1 2. Constant speed curve 2 3. Constant speed curve 3 4. Proportional pressure curve low 5. Proportional pressure curve high 6. Constant differential pressure curve low 7. Constant differential pressure curve high

be
think
innovate

GRUNDFOS

ALPHA1 KEY FEATURES

Everything under control

- 7-segment power display provides an easy overview of all that is going on in the pump

Proportional pressure mode

- If the proportional pressure mode is selected, the differential pressure varies proportionally with the flow, i.e. higher flow means higher differential pressure
- Proportional pressure is the preferred choice for one-string systems with high flow variation
- Proportional pressure curve (high and low)

Constant speed mode

- Three constant speed modes for constant flow applications



Constant pressure mode

- The pump maintains constant pressure regardless of the flow
- The preferred operation mode for under floor heating and 2 string systems with low flow variation
- Constant pressure curves (low and high)

Easy operation

- Intuitive one-touch operation makes control mode selection simple

Easy connection

- The improved ALPHA plug makes electrical installation easier than ever before

TYPES AND DIMENSIONS

| Pump type | ≤EEI | Dimensions (mm) | | | | | | | | | | Insulation Shells (set) | Product number |
|---------------------------------|------|-----------------|----|----|----|----|----|-----|----|----|--------|-------------------------|----------------|
| | | L1 | B1 | B2 | B3 | B4 | H1 | H2 | H3 | G | | | |
| ALPHA1 15-40 130 1x230V 50Hz 6H | 0.23 | 130 | 78 | 78 | 46 | 49 | 27 | 129 | 58 | 1 | 505821 | 98475900 | |
| ALPHA1 15-50 130 1x230V 50Hz 6H | 0.23 | 130 | 78 | 78 | 46 | 49 | 27 | 129 | 58 | 1 | 505821 | 98475904 | |
| ALPHA1 15-60 130 1x230V 50Hz 6H | 0.23 | 130 | 78 | 78 | 46 | 49 | 27 | 129 | 58 | 1 | 505821 | 98475906 | |
| ALPHA1 20-40 130 1x230V 50Hz 6H | 0.23 | 130 | 78 | 78 | 46 | 49 | 27 | 129 | 58 | 1¼ | 505821 | 98475910 | |
| ALPHA1 20-50 130 1x230V 50Hz 6H | 0.23 | 130 | 78 | 78 | 46 | 49 | 28 | 129 | 58 | 1¼ | 505821 | 98475922 | |
| ALPHA1 20-60 130 1x230V 50Hz 6H | 0.23 | 130 | 78 | 78 | 46 | 49 | 27 | 129 | 58 | 1¼ | 505821 | 98475927 | |
| ALPHA1 25-40 180 1x230V 50Hz 6H | 0.23 | 180 | 78 | 78 | 46 | 48 | 26 | 127 | 81 | 1½ | 505821 | 98475930 | |
| ALPHA1 25-40 130 1x230V 50Hz 6H | 0.23 | 130 | 78 | 78 | 46 | 49 | 27 | 129 | 79 | 1½ | 505821 | 98475932 | |
| ALPHA1 25-50 130 1x230V 50Hz 6H | 0.23 | 130 | 77 | 78 | 46 | 49 | 27 | 129 | 79 | 1½ | 505821 | 98475933 | |
| ALPHA1 25-50 180 1x230V 50Hz 6H | 0.23 | 180 | 78 | 77 | 47 | 48 | 26 | 127 | 81 | 1½ | 505821 | 98475934 | |
| ALPHA1 25-60 130 1x230V 50Hz 6H | 0.23 | 130 | 77 | 78 | 46 | 49 | 27 | 129 | 79 | 1½ | 505821 | 98475935 | |
| ALPHA1 25-60 180 1x230V 50Hz 6H | 0.23 | 180 | 78 | 77 | 47 | 48 | 26 | 127 | 81 | 1½ | 505821 | 98475936 | |
| ALPHA1 32-40 180 1x230V 50Hz 6H | 0.23 | 180 | 78 | 78 | 47 | 48 | 26 | 127 | 81 | 2 | 505821 | 98475938 | |
| ALPHA1 32-50 180 1x230V 50Hz 6H | 0.23 | 180 | 78 | 77 | 47 | 48 | 26 | 127 | 81 | 2 | 505821 | 98475939 | |
| ALPHA1 32-60 180 1x230V 50Hz 6H | 0.23 | 180 | 78 | 77 | 47 | 48 | 26 | 127 | 81 | 2 | 505821 | 98475940 | |

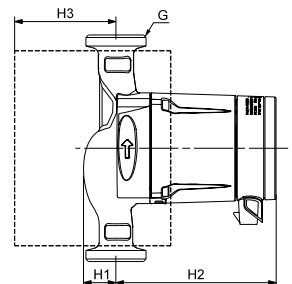
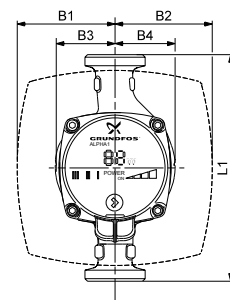

ALPHA1 is also available in stainless steel and airvent versions.

GRUNDFOS Holding A/S
Poul Due Jensens Vej 7
DK-8850 Bjerringbro
Tel: +45 87 50 14 00
www.grundfos.com

