



## LAARS<sup>®</sup>-Stor SS Energy Saver Stainless Steel Indirect Water Heater

---

---

### Features:

- **CFC free polystyrene insulation**—Form fitted and molded, this system contributes to greater heat retention, improved overall efficiency and reduced standby heat loss.
- **Aquastat**—Factory installed.
- **Stainless steel tank and heat exchanger**—Made from chromium molybdenum - titanium ferritic 444 stainless steel alloy.
- **Supply and Return Connections**—The ¾" NPT female connections are located on the front for both the boiler supply and boiler return. (1" NPT on LS-RTV-119)
- **Jacket**—Corrosion and dent resistant plastic casing.
- **Stand-by heat loss**—Less than ½°F per hour.
- **Brass Drain/Return Valve**
- **T&P relief valve opening**—All models have special tapping on top of tank.
- **Warranty**—Residential models have a limited lifetime warranty on the tank and heat exchanger. The LS-RTV-119 is a commercial model and is furnished with a 5 year warranty on the tank and heat exchanger. For more details please refer to the complete copy of the warranty included with the heater.
- **Six-year limited warranty on parts.**

MANUFACTURED UNDER ONE OR MORE OF THE FOLLOWING U.S. PATENTS: 5,954,492; 5,761,379; 5,943,984; 5,081,696; 5,988,117; 6,142,216; 5,199,385; 6,684,821; 5,574,822; 5,372,185; 5,485,879; 5,277,171; (B1)5,341,770; 5,660,165; 5,596,952; 5,682,666; 4,904,428; 5,023,031; 5,000,893; 4,669,448; 4,829,983; 4,808,356; 5,115,767; 5,092,519; 5,052,346; 4,416,222; 4,628,184; 4,861,968; 4,672,919; Re. 34,534. OTHER U.S. AND FOREIGN PATENT APPLICATIONS PENDING. CURRENT CANADIAN PATENTS: 1,272,914; 1,280,043; 1,289,832; 2,045,862; 2,112,515; 2,108,186; 2,107,012, 2,092,105.

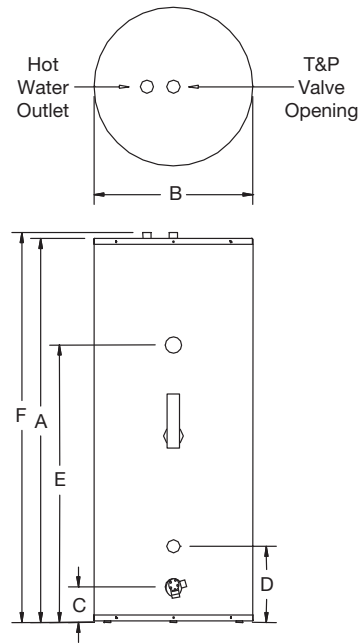

Photo is of LS-RTV-52-L

# LAARS®-Stor SS Energy Saver Stainless Steel Indirect Water Heater

## Energy Saver Models

These water heaters meet or exceed the insulating standards established under ASHRAE Standard 90.1b (current edition).



## LAARS®-Stor SS

### Specifications

Model	Volume Gallons	Dimensions											Shipping Weight lbs kg
		A Height in cm	B Dia. in cm	C Cold Supply in cm	D Boiler Return in cm	E Boiler Supply in cm	F Ht. to HW Outlet in cm	Return in cm	Supply in cm				
LS-RTV-40-L	39.6	38 97	23 <sup>3</sup> / <sub>4</sub> 60	7 <sup>1</sup> / <sub>4</sub> 18	11 <sup>1</sup> / <sub>2</sub> 29	27 <sup>1</sup> / <sub>4</sub> 69	38 <sup>1</sup> / <sub>2</sub> 98	— —	— —	— —	83 38		
LS-RTV-52-L	51.3	47 <sup>3</sup> / <sub>4</sub> 121	23 <sup>3</sup> / <sub>4</sub> 60	7 <sup>1</sup> / <sub>4</sub> 18	11 <sup>1</sup> / <sub>2</sub> 29	27 <sup>3</sup> / <sub>4</sub> 71	48 <sup>1</sup> / <sub>4</sub> 123	— —	— —	— —	93 42		
LS-RTV-75-L	74.5	65 <sup>1</sup> / <sub>2</sub> 166	23 <sup>3</sup> / <sub>4</sub> 60	7 <sup>1</sup> / <sub>4</sub> 18	11 <sup>1</sup> / <sub>2</sub> 29	28 71	66 168	— —	— —	— —	117 53		
LS-RTV-75D-L	74.5	65 <sup>1</sup> / <sub>2</sub> 166	23 <sup>3</sup> / <sub>4</sub> 60	7 <sup>1</sup> / <sub>4</sub> 18	11 <sup>1</sup> / <sub>2</sub> 29	27 <sup>1</sup> / <sub>2</sub> 70	66 168	38 97	54 137	— —	130 59		
LS-RTV-119-L	118.9	62 158	31 79	10 <sup>1</sup> / <sub>4</sub> 26	16 <sup>3</sup> / <sub>4</sub> 43	44 <sup>3</sup> / <sub>8</sub> 113	62 <sup>1</sup> / <sub>2</sub> 159	— —	— —	— —	315 142		

- Notes:
- 1) Inlet water temperature based on 50°F.
  - 2) LS-RTV-75D-L has 2 coils.
  - 3) LS-RTV-119 supplied with 3 extra plugged tappings (see manual).
  - 4) LS-RTV-119 equipped with steel casing.
  - 5) 3/8" supply/return piping is recommended on heat source side.

### General

All units are certified at 300 PSI (2068 kPa) test pressure and 150 PSI working pressure (1034 kPa).

All potable water connections are 3/4" (19mm) NPT (1 1/4" (32mm) NPT on LS-RTV-119).

*Dimensions and specifications subject to change without notice in accordance with our policy of continuous product improvement.*

Model	Coil Capacity		Performance							
	USG	Liters	Heat Surface Area (ft <sup>2</sup> )	Boiler Flow US GPM	Gross Boiler Output BTU/HR	Pressure Drop (Ft. W.C.)	@180°F Supply @90°F Rise		@200°F Supply @90°F Rise	
LS-RTV-40-L	1.17	4.43	7.64	11	136,000	5.3	151	111	182	141
LS-RTV-52-L	1.56	5.91	10.01	11	173,000	8.7	192	141	231	180
LS-RTV-75-L	1.56	5.91	10.01	11	190,000	8.7	216	136	253	173
LS-RTV-75D-L	2.34	8.86	15.28	22	265,000	10.6	295	215	355	275
LS-RTV-119-L	4.60	17.4	21.31	15	252,000	3.1	298	178	337	217

### 6-Year Limited Warranty on Component Parts

LAARS HEATING SYSTEMS has a 6-year warranty on replaceable parts—thermostat, drain valve. These quality components are manufactured for us by industry leaders and will be replaced in the event of failure during the parts warranty period (exclusive of shipping and re-installation cost.)§

### Limited Lifetime Tank and Heat Exchanger Warranties

LAARS HEATING SYSTEMS LIMITED WARRANTY: Protects your investment in a quality stainless steel water heater and heat exchanger. If the tank or heat exchanger leaks for reasons of faulty materials, workmanship, or corrosion within the warranty period, the entire unit will be replaced with a comparable unit of our manufacture (exclusive of shipping and re-installation cost.)§

§ Some states and provinces do not allow limitations on warranties. For products installed in USA, Canada and Puerto Rico, see complete copy of the warranty included with the heater.